

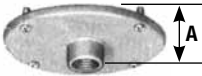

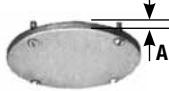

# JB Conduit Outlet Boxes, Covers and Hangers

UNILETS™ for use with Threaded Rigid Metal Conduit and IMC.

NEC:

Listed for Ordinary Locations

Description	Hub Size (Inches)	Depth in Millimeters (Inches) (A)	Catalog Number	
			Malleable Iron	Aluminum
<b>Cast Covers — Furnished with screws — When used with gasket provides raintight fit, supports 113.4 kg (250 lb)</b>				
 Hub Covers	1/2	20.0 (0.75)	<b>JBK-50</b>	<b>JBK-50-A</b>
	3/4	23.9 (0.94)	<b>JBK-75</b>	<b>JBK-75-A</b>
 Cover	Blank	4.8 (0.19)	<b>JBK-B</b>	<b>JBK-1B-CA</b>
<b>Gasket — Neoprene</b>				
	—	—	<b>JB-GK-N</b>	<b>JB-GK-N</b>
<b>Flexible Fixture Hangers — Furnished with gasket and screws</b>				
 Ball Type — 15° swing in all directions, support 113.4 kg (250 lb)	1/2	65.0 (2.56)	<b>JBK-50-BS</b>	—
	3/4	65.0 (2.56)	<b>JBK-75-BS</b>	—
 Cushion type, enclosed and gasketed — 8° swing in all directions. Cushions 18.1 kg (40 lb), supports 113.4 kg (250 lb)	1/2	41.4 (1.63)	<b>JBK-50-CS</b>	—
	3/4	41.4 (1.63)	<b>JBK-75-CS</b>	—

## Dimensions in Millimeters (Inches)

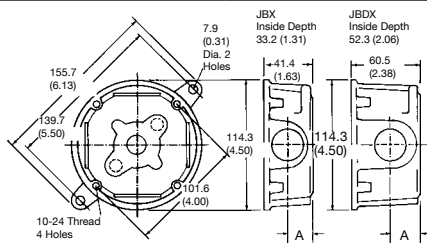

JBX, JBDX

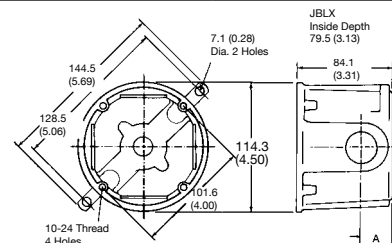

JBLX

Hub Size (Inches)	Dimension "A" in Millimeters (Inches)		
	JBX	JBDX	JBLX
1/2	19.1 (0.75)	19.1 (0.75)	19.1 (0.75)
3/4	22.4 (0.88)	22.4 (0.88)	22.4 (0.88)
1	20.6 (0.81)	26.9 (1.06)	26.9 (1.06)

## Wiring Capacity ①

Hub Size (Inches)	dm <sup>3</sup> (in <sup>3</sup> )		
	JBX	JBDX	JBLX
1/2	15.50 (0.25)	23.00 (0.38)	33.00 (0.54)
3/4	15.50 (0.25)	23.00 (0.38)	33.00 (0.54)
1	15.50 (0.25)	23.00 (0.38)	33.00 (0.54)

① JB covers add no additional cubic inch capacity.